



**pTank Float, Float X0.5 & Column Construction
Guide**

**Pico Float, Float X0.5, Column Tank Building Guide –
Rev 0.3 NOV 2021
www.pTank.co.uk**

Kit Parts



Also Required

- Tensol 12 (or similar) Acrylic Adhesive
- Flat worktop/area for assembly
- Angle Plate, pTank Build Block or Heavy Weight to support sides (ie can of beans!)
- Masking Tape

Construction

Before Starting

Thank you for your purchase. Use the acrylic adhesive as intended, according to the **instructions and any safety data sheets**. Wear appropriate PPE (gloves and safety glasses). Ensure you work in a **well ventilated** area,

ideally outside, to allow the solvent vapours to disperse.

Although you can add more adhesive to seal any leaks, after construction is complete, a far cleaner finish will be obtained if slightly more adhesive is applied during build and removed when partially cured. Practice on the test samples provided to get an idea of how much adhesive to apply to fill the joint. A correctly filled joint will look water clear, when viewed from the outside, with protective film removed. Use the practice parts to also get an idea of how long it takes for a joint to partially cure and be stable enough to continue construction.

Step 1 – Remove Bond Area Film

If not already completed on the supplied parts, carefully peel back the small 5mm width strips of protective film to reveal the surfaces to be bonded. The front and rear parts have 3 strips,

Pico Float, Float X0.5, Column Tank Building Guide –
Rev 0.3 NOV 2021
www.pTank.co.uk

the sides 1 each. **Leave all other sections of protective film on.**



Step 2 – Apply 1st Adhesive Bead

Using a syringe tip or dropper bottle, apply a bead of Acrylic adhesive (Tensol 12 recommended) to the left side of the Front part, as shown in green below. Ensure a continuous bead is applied, with no gaps and the bead almost fills the width of the exposed plastic. Any

excess adhesive can be removed when partially dry.

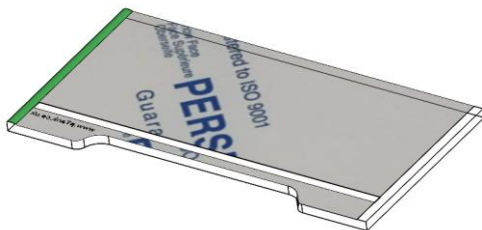

Step 3 – Place LHS Part

Take the LHS part and place the short edge onto the exposed adhesive bead. Ensure the Perspex branded face is inwards, so the exposed portions of plastic align.

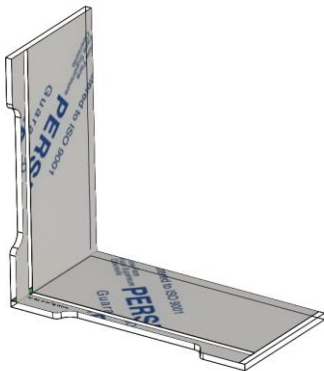

Step 4 – Support LHS Part

Use a heavy item tin of beans etc, a pTank Build Block (shown below) or Angle Plate to support the LHS as the adhesive cures. If using an Angle Plate or Build Block, use a magnet on the outer face to secure

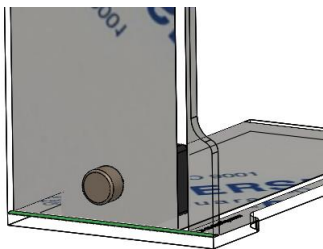
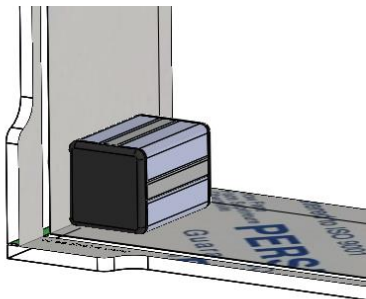

Step 5 – Align LHS Part

Before the adhesive cures, check the mating faces of the parts are flush and the exposed bonding faces are aligned. Use the flat faces of two Spacers to check parts are flush and nudge the faces into the correct position.

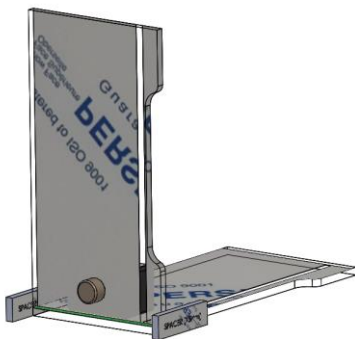



Allow the adhesive to cure for at least 20 minutes to allow you to continue the build without disturbing the first bonded part. It may take longer than 20 mins for the bond to become stable, depending on environmental conditions. Whilst waiting, maybe have a cuppa and research that next Aquascape/Tank setup!

Step 6 – Apply Base Adhesive

Apply another bead of adhesive to the exposed face on the front part, be careful to limit the adhesive to the horizontal exposed face.

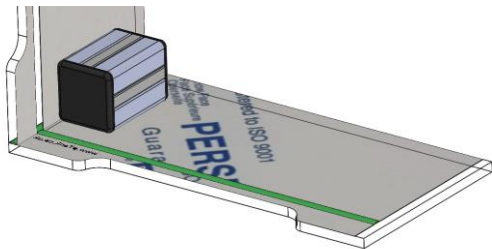

Take the Base plate and apply a bead of adhesive to one edge (any edge as the part is square).



Step 7 – Position Base

Position the Base, on the existing Front and locate on the LHS. Use the Spacer parts to position and check all edges are flush.

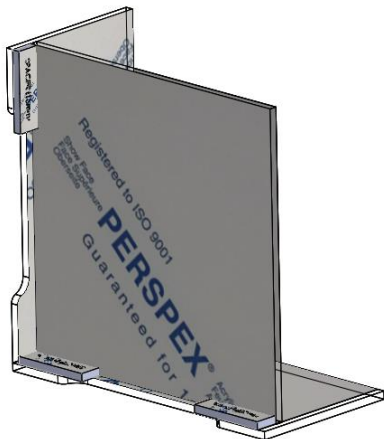



Step 8 – Secure Base

Use masking tape to hold the corners of the assembly whilst the adhesive starts to cure.

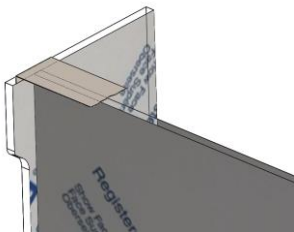

Step 9 – Bonding RHS

Apply a bead of adhesive to the right of the Back part, the last exposed section, and the exposed section on the RHS part. Allow to cure for 20mins.

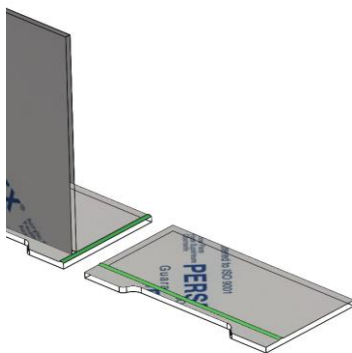

Step 10 – Locating & Securing the RHS Part

Lift the RHS part into place, as before, use the spacers to check all edges are flush, secure with more masking tape. Allow to cure for 20 mins.

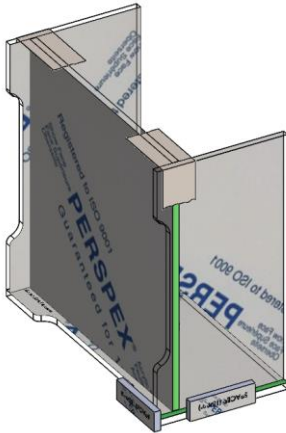

Step 11 – Bonding Front

Carefully remove the masking tape. Run three beads of adhesive along the existing exposed edges, place the Front part on the top of the assembly. Use the spacers to position and check all edges are flush. Secure with Masking tape.

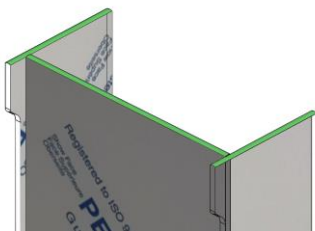



Step 12 – Excess Adhesive Removal

Before the adhesive starts to harden (>2hrs), any excess can be carefully peeled away, whilst in a jelly like state. Use the corner of a Spacer as a scraper, or carefully use a razor blade to lift

the more difficult to reach portions of excess adhesive.

Remove all the remaining protective film, remove any remaining excess partially cured adhesive.

Step 13 – Water Test & Re-Work

Allow at least 24 hours before filling with water. Any minor leaks can be sealed by draining the tank, drying the area in question and then running a small bead of adhesive over the leak.

Step 14 – Lid (pTank Pico Column Only)

Apply the 4 self adhesive feet to the base of the lid (logo facing in). Apply close to the corners so the feet locate on the edge of the tank, creating a small air gap and retaining the lid.

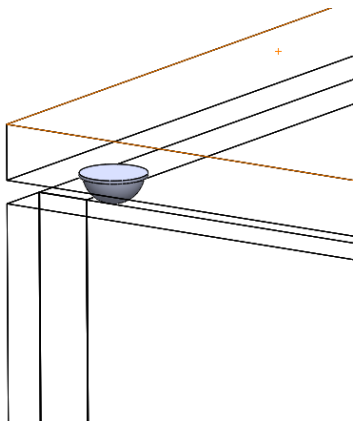

Pico Float, Float X0.5, Column Tank Building Guide –
Rev 0.3 NOV 2021
www.pTank.co.uk